

SUCTION CUPS / Flat

VF50



Features and Strengths

Specifically designed for flat and curved surface
Available to handle multiple objects with the same suction cup

Examples of use

Metal sheet, Veneer sheets, Glass, Electronic components



Recommended Lifting Force (Max.)

Model	Volume (cm ³)	Lifting Force (Kg) - Perpendicular			Lifting Force (Kg) - Parallel		
		- 20 kPa	- 60 kPa	- 90 kPa	- 20 kPa	- 60 kPa	- 90 kPa
VF50	10.00	3.67	7.55	9.79	2.44	4.08	5.10

※ The lifting force above does not include safety factor

Material Specifications

Material	Hardness Shore (°)	Color	Temperature (°C)
NBR	60	Black	-20~110
Silicone	55	Red	-70~200
White Silicone	55	Translucent White	-70~200
White Silicone (FDA)	55	Translucent White	-70~200
High temp. Silicone	50	Blue	-70~280
Conductive Silicone	70	Smoky Black	-45~90
Urethane	60	Dark Green	0~100
Mark Free	75	Black	-10~100
Polyurethane	60	Translucent Orange	0~60

Material Resistance

Description	NBR	Silicone	White Silicone	High temp. Silicone	Conductive Silicone	Urethane	Mark Free	Polyurethane
Wear Resistance	Excellent	Good	Good	Good	Good	Excellent	Good	Excellent
Oil	Excellent	Poor	Poor	Poor	Poor	Excellent	Excellent	Excellent
Weather / Ozone	Fair	Excellent	Excellent	Excellent	Excellent	Excellent	Excellent	Excellent
Alcohol	Good	Good	Good	Good	Good	Fair	Good	Fair
Acid	Fair	Poor	Poor	Poor	Poor	Poor	Excellent	Fair

Dimension

[Unit : mm]

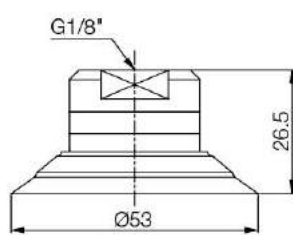

[With 18F fitting]

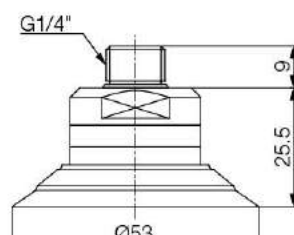

[With 14M fitting]

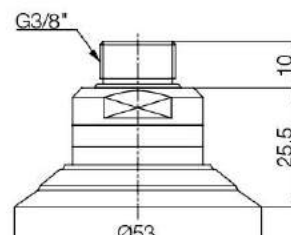

[With 38M fitting]



I Build an Ordering No.

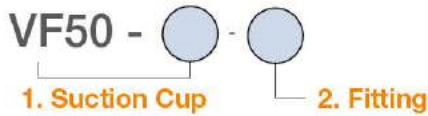

1. Suction cup	Description	Symbol
	Flat suction cup, 50mm diameter, Nitrile (NBR)	VF50-N
	Flat suction cup, 50mm diameter, Silicone	VF50-S
	Flat suction cup, 50mm diameter, White silicone	VF50-WS
	Flat suction cup, 50mm diameter, White silicone (FDA)	VF50-WS (FDA)
	Flat suction cup, 50mm diameter, High temperature silicone	VF50-HS
	Flat suction cup, 50mm diameter, Conductive silicone	VF50-CS
	Flat suction cup, 50mm diameter, Urethane	VF50-U
	Flat suction cup, 50mm diameter, Mark free	VF50-A
	Flat suction cup, 50mm diameter, Polyurethane	VF50-PU
2. Fitting	Description	Symbol
	Fitting, G1/8 female	18F
	Fitting, G1/8 female, Mesh filter	M-18F
	Efficiency valve, Fitting, G1/8 female	18F-EV
	Fitting, G1/8 female, Button valve	18F-BV
	Fitting, G1/8 female, Old profile	18FO
	Fitting, G1/8 female, Old profile, Mesh filter	M-18FO
	Efficiency valve, Fitting, G1/8 female, Old profile	18FO-EV
	Fitting, G1/4 male	14M
	Fitting, G1/4 male, Mesh filter	M-14M
	Efficiency valve, Fitting, G1/4 male	14M-EV
	Fitting, G3/8 male	38M
	Fitting, G3/8 male, Mesh filter	M-38M
	Efficiency valve, Fitting, G3/8 male	38M-EV

I Spare Parts – Rubber Parts

Part No.	Description	Weight (g)	Color
VF50-N	Flat suction cup, 50mm diameter, Nitrile (NBR)	12.25	Black
VF50-S	Flat suction cup, 50mm diameter, Silicone	11.88	Red
VF50-WS	Flat suction cup, 50mm diameter, White silicone	11.88	Translucent White
VF50-WS (FDA)	Flat suction cup, 50mm diameter, White silicone (FDA)	11.88	Translucent White
VF50-HS	Flat suction cup, 50mm diameter, High temperature silicone	11.88	Blue
VF50-CS	Flat suction cup, 50mm diameter, Conductive silicone	11.98	Smoky Black
VF50-U	Flat suction cup, 50mm diameter, Urethane	12.30	Dark Green
VF50-A	Flat suction cup, 50mm diameter, Mark free	14.20	Black
VF50-PU	Flat suction cup, 50mm diameter, Polyurethane	11.18	Translucent Orange

I Dimension

[Unit : mm]

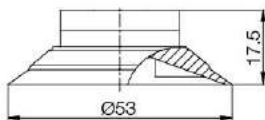

[Rubber Part]

I Spare Parts – Fittings

Part No.	Part No.	Description	Weight (g)
350 000 3312	18F	G1/8 female	14.47
350 000 4312	18F-F	G1/8 female, Mesh filter	14.58
350 010 3312	18F-EV	Efficiency valve, G1/8 female	15.81
350 020 3312	18F-BV	G1/8 female, Button valve	14.86
350 000 1312	18FO	G1/8 female, Old profile	10.12
350 000 4912	18FO-F	G1/8 female, Old profile, Mesh filter	10.2
350 010 1312	18FO-EV	Efficiency valve, G1/8 female, Old profile	10.22
350 000 3405	14M	G1/4 male	14.18
350 000 3805	14M-F	G1/4 male, Mesh filter	14.42
350 010 3405	14M-EV	Efficiency valve, G1/4 male	14.38
350 000 3505	38M	G3/8 male	18.14
350 000 3905	38M-F	G3/8 male, Mesh filter	17.75
350 010 3505	38M-EV	Efficiency valve, G3/8 male	17.53